

Darlington Upgrade Project

Changed access to Southern Expressway & Main South Road traffic restrictions, Bedford Park October & November 2019

As part of the Darlington Upgrade Project, access to the Southern Expressway via the Main South Road on-ramp from Flinders Drive, will be closed from 8pm Sunday 13 October until late November.

This temporary closure is required to facilitate piling works.

During this time, motorists wanting to access the Southern Expressway will need to enter the lowered motorway at the Ayliffes Road and South Road intersection or access via the Marion Road on-ramp.

Motorists will still be able to turn left out of Flinders Drive to enter the lowered motorway as per current arrangements.

The works will also result in traffic restrictions on the southbound carriageway of Main South Road, between Sturt Road and Flinders Drive to safely accommodate the piling rig and construction activities.

Two lanes of southbound traffic through this section of Main South Road will reduce to one lane between the hours of 8pm-6am each night until mid November.

A piling rig, excavators, lighting towers, cranes and trucks will be used.

Signage will alert motorists to the changed traffic conditions.

Please refer to the map overleaf for additional information.

Works will be managed to minimise disturbance to local residents however some noise can be expected.

If you have any questions or would like to speak to a member of the project team, please call 1300 759 334 or email: enquiries@gatewaysouth.com.au

Thank you for your patience while these important works are undertaken.

Kind Regards,
Darlington Upgrade Project Team

28 October 2019

Changed access to Southern Expressway Main South Road traffic restrictions October & November 2019

The Main South Road on-ramp to the Southern Expressway will be temporarily closed from 8pm Sunday 13 October until late November.

Southbound motorists wanting to access the Southern Expressway will need to enter the lowered motorway from the Ayliffes Road/South Road or the Marion Road on-ramp.

Aside from the movements highlighted on the plan below, all other movements will remain as they currently are.

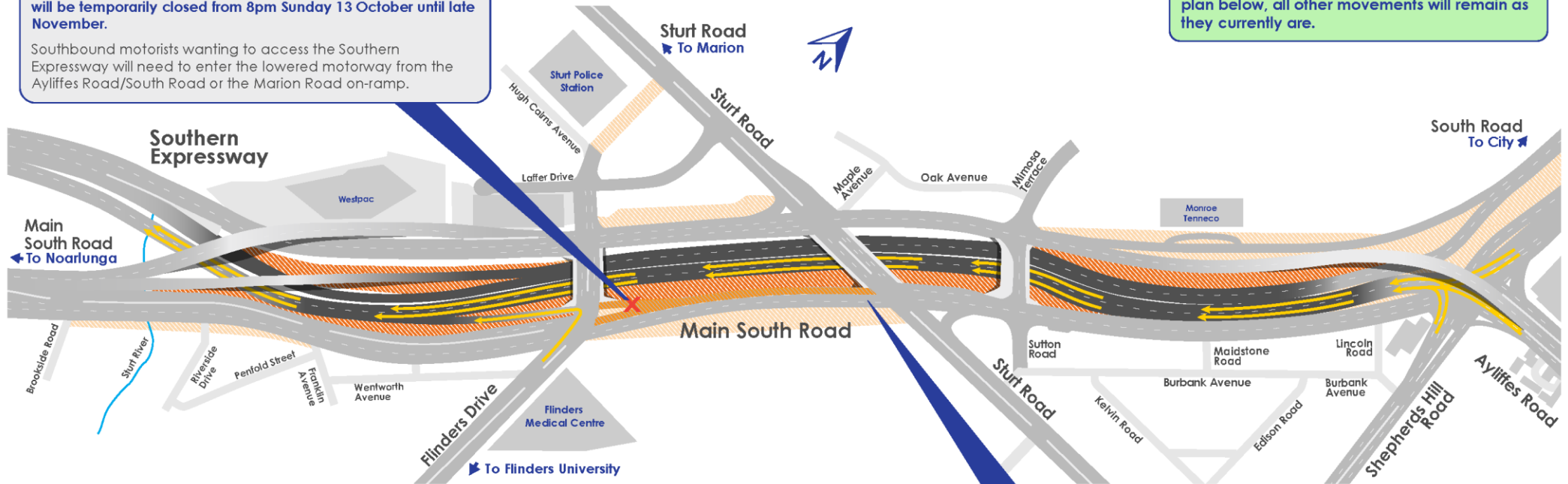

Legend

Work Zone - surface roads	Surface roads	Road closed
Work Zone - lowered motorway	Lowered motorway	Motorway access to Southern Expressway

Southbound traffic lanes on Main South Road between Sturt Road and Flinders Drive will be reduced during the works to safely accommodate the piling rig.
Two lanes of traffic will be available during the day and one lane of traffic will be available during nightworks. Nightworks will occur between the hours of 8pm-6am each night until mid-November.