

# North-South Corridor

## Northern Connector Project

### Changes to Bolivar Road, southbound access to Port Wakefield Road

From 5am Friday 7 June 2019, a new slip lane from Bolivar Road to Port Wakefield Road will be opened, maintaining access for southbound traffic (refer to map).

This new slip lane forms part of the Bolivar Road upgrade that will connect to the Bolivar Interchange, which, when complete, will provide access to the Northern Connector.

The Northern Connector Project is scheduled for completion late 2019.

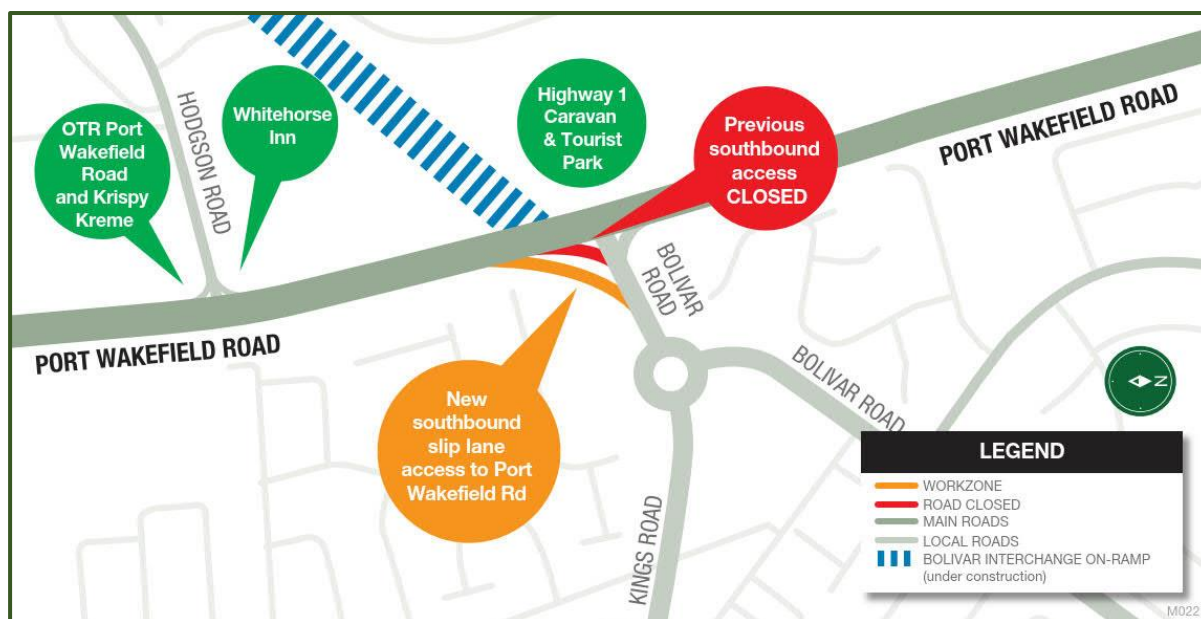

Thank you for your patience while these important works are undertaken.

**More information:** To sign up for traffic updates, please contact the Project Information Line on 1300 916 221 or email your contact details to [northernconnector@lendlease.com](mailto:northernconnector@lendlease.com).

For real time roadwork information visit [www.addinsight.com](http://www.addinsight.com) or visit the Traffic SA website at [www.traffic.sa.gov.au](http://www.traffic.sa.gov.au).

Follow [www.facebook.com/DPTISA](https://www.facebook.com/DPTISA) for regular project updates.

#14069831

#### For further information:

Call: 1300 916 221

Email: [northernconnector@lendlease.com](mailto:northernconnector@lendlease.com)

Visit: [dpti.sa.gov.au/northernconnector](http://dpti.sa.gov.au/northernconnector)