

Darlington Upgrade Project

17 March

Main South Road night works

As part of the Darlington Upgrade Project, Main South Road southbound will be closed between Flinders Drive and just south of Franklin Avenue, Bedford Park, in preparation for final asphalt.

These works will be undertaken from 8pm Tuesday, 17 March until 6am Wednesday, 18 March.

Main South Road southbound motorists wanting to access Bedford Park, south of Flinders Drive, will need to detour via Sturt Road, Marion Road and then Main South Road northbound.

Motorists wanting to travel south at the Flinders Drive intersection with Main South Road will be detoured via Main South Road northbound, Sturt Road, and then Marion Road.

Please see map overleaf.

Access into Flinders Drive will not be impacted.

Access to the Southern Expressway southbound from Flinders Drive will be maintained during these works.

Access for emergency service vehicles, pedestrians and cyclists will be maintained at all times during these works.

Bus stops 28 and 29 (southbound) on Main South Road will be temporary closed. For further information regarding changes to bus stops, detours and timetables please visit www.adelaidemetro.com.au

Some noise disturbance can be expected at times while these works are completed, however the work will be managed to minimise disturbance to local residents as much as practically possible.

Please plan ahead, allow extra travel time and take extra care when workers are on site. Observe speed limits, lane restrictions and traffic controllers when travelling through the area.

If you have any questions or would like to speak to a member of the project team, please call 1300 759 334 or email: enquiries@gatewaysouth.com.au.

Thank you for your patience while these important works are undertaken.

Kind Regards,
Darlington Upgrade Project Team

13 March 2020

Main South Road night works Bedford Park March 2020

Legend

-  Surface roads
-  Southern Expressway (lowered motorway)
-  Road closed
-  Road closed area
-  Work Zone - surface roads
-  Work Zone - lowered motorway
-  Detour southbound traffic
-  Local traffic access
-  Bus stop
-  Bus stop temporarily closed during construction

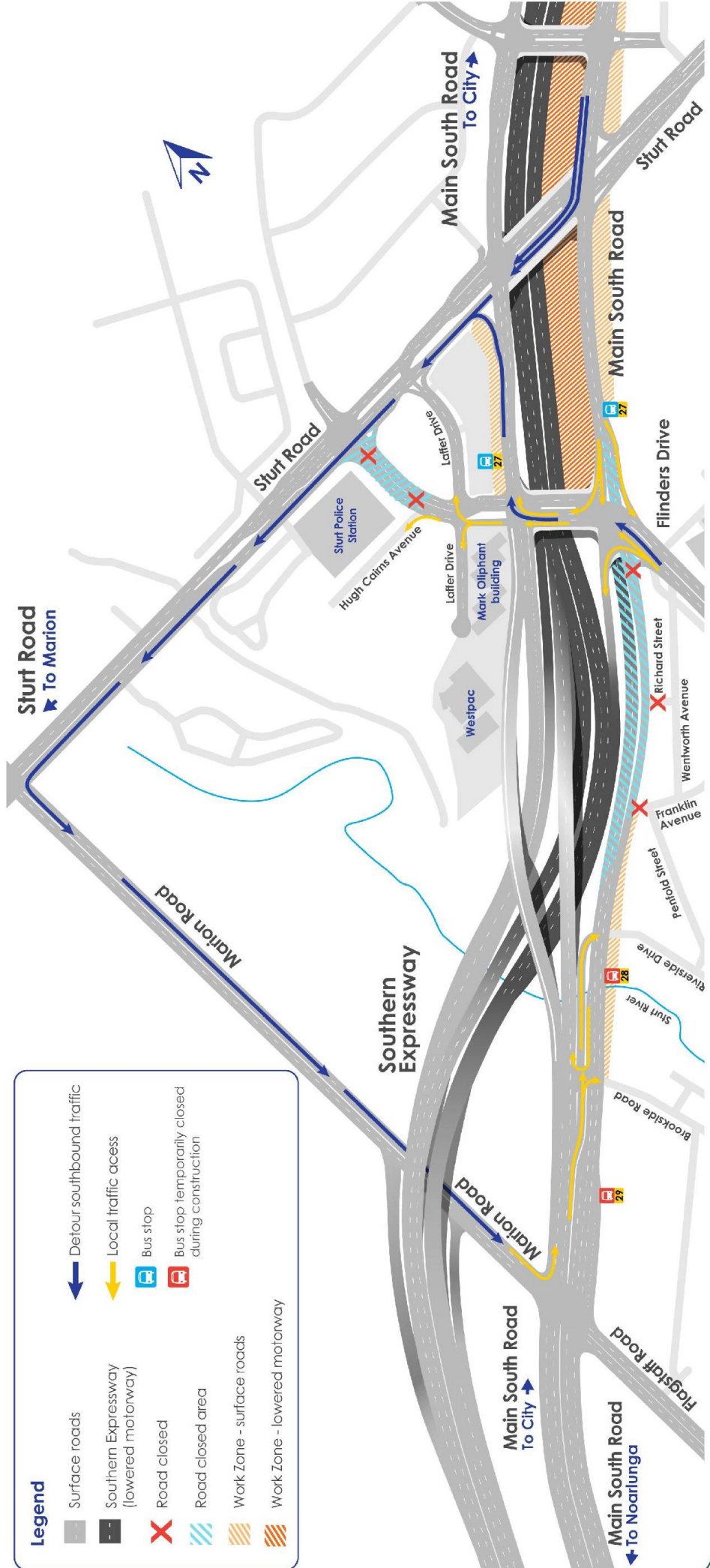

Australian Government
BUILDING OUR FUTURE



Government of South Australia
Department of Planning,
Transport and Infrastructure