

PAVEMENT JOINT TYPE 5

TRANSVERSE JOINT
 FULL DEPTH ASPHALT - THIN ASPHALT ON GRANULAR
 (TRANSVERSE CONSTRUCTION JOINT AT CHANGE FROM FULL DEPTH ASPHALT TO THIN ASPHALT ON GRANULAR)

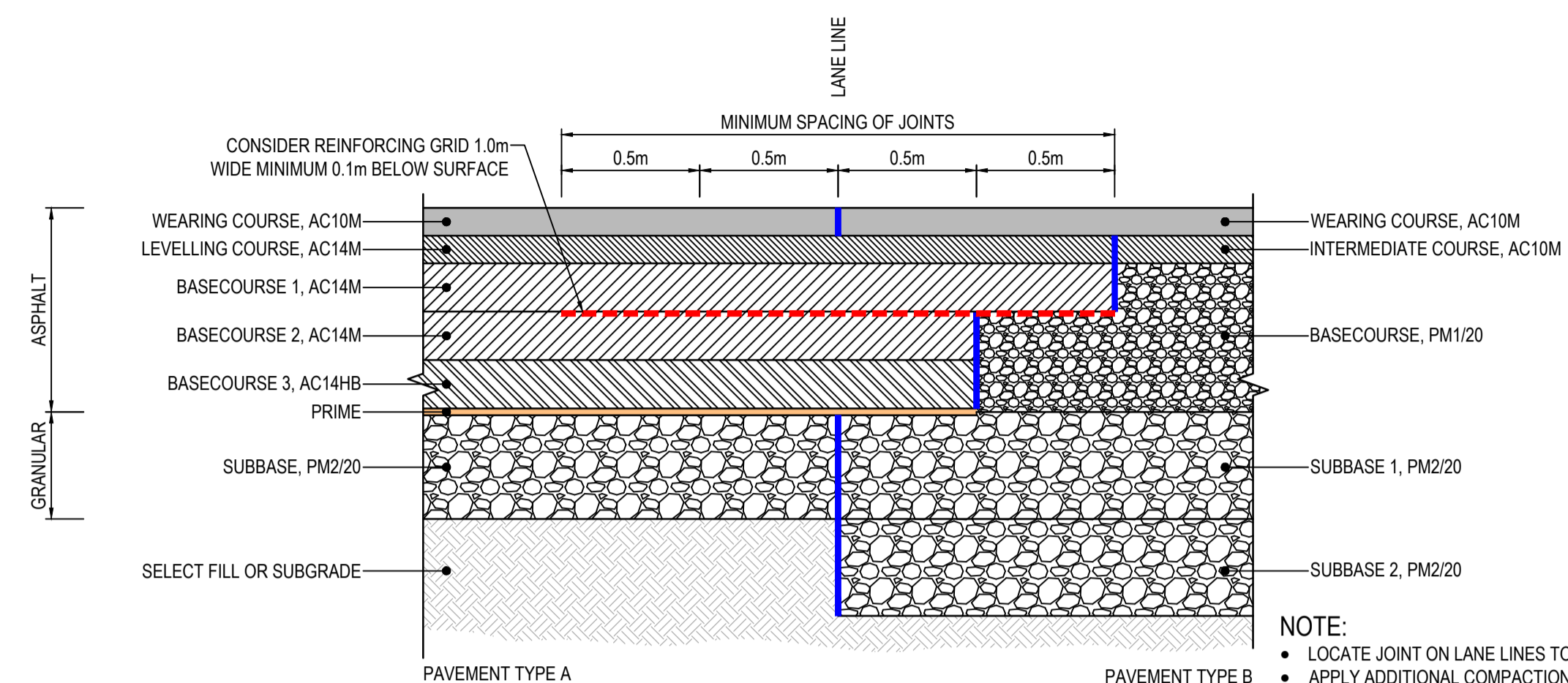

PAVEMENT JOINT TYPE 6

LONGITUDINAL JOINT
 FULL DEPTH ASPHALT - THIN ASPHALT ON GRANULAR
 (LONGITUDINAL CONSTRUCTION JOINT AT CHANGE FROM FULL DEPTH ASPHALT TO THIN ASPHALT ON GRANULAR)

- NOTE:
- LOCATE JOINT ON LANE LINES TO AVOID WHEEL PATHS.
 - APPLY ADDITIONAL COMPACTION ALONG JOINT. e.g. HAND RAMMER AND MULTI-TYRED ROLLER AT OMC.
 - ADDITIONAL DENSITY TESTING REQUIRED ALONG JOINT.

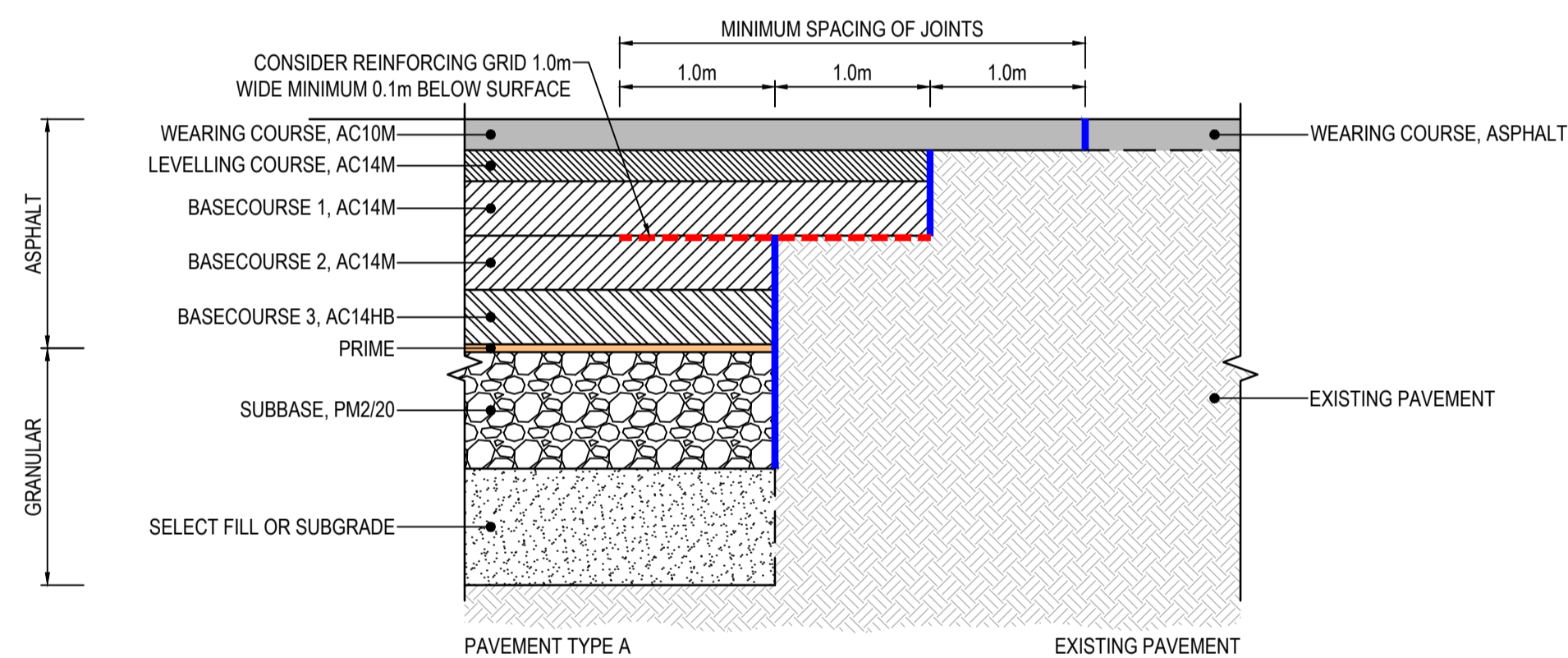

PAVEMENT JOINT TYPE 7

TRANSVERSE JOINT
 FULL DEPTH ASPHALT - EXISTING PAVEMENT
 (TRANSVERSE CONSTRUCTION JOINT AT LIMIT OF WORKS)

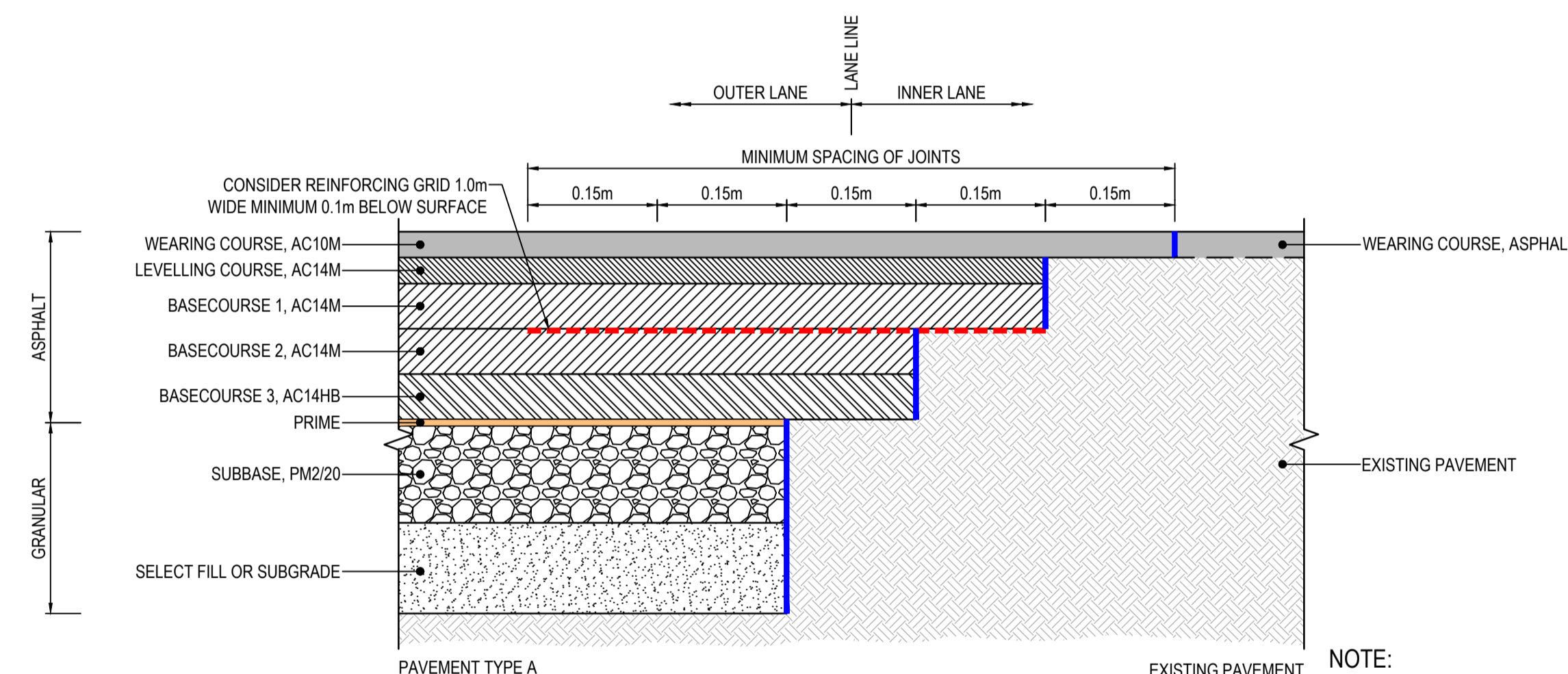

PAVEMENT JOINT TYPE 8

LONGITUDINAL JOINT
 FULL DEPTH ASPHALT - EXISTING PAVEMENT
 (LONGITUDINAL CONSTRUCTION JOINT AT LIMIT OF WORKS)

- NOTE:
- LOCATE JOINT ON LANE LINES TO AVOID WHEEL PATHS.
 - APPLY ADDITIONAL COMPACTION ALONG JOINT. e.g. HAND RAMMER AND MULTI-TYRED ROLLER AT OMC.
 - ADDITIONAL DENSITY TESTING REQUIRED ALONG JOINT.

NOTES:

- THE GENERIC JOINT DETAIL INDICATES TYPICAL REQUIREMENTS. IT MUST BE REVIEWED AND ADJUSTED FOR EACH PROJECTS SPECIFIC CONDITIONS. ASPHALT MIXES ARE INDICATIVE ONLY. ASPHALT MIXES ARE INDICATIVE ONLY, ACTUAL TYPES TO BE DETERMINED FROM PAVEMENT SCHEDULE. e.g. IF O614 IS TO REPLACE SMA10, ADOPT SAMI MEMBRANE.
- REMOVE ANY DEFECTIVE MATERIAL (E.G. LOOSE, CRACKED, SETTLED, DEFORMED, ERODED, POORLY COMPACTED, TEMPORARY RAMPS etc) AT THE JOINT PRIOR TO PLACING NEXT PAVEMENT.
- ASPHALT - FACE OF JOINTS AND PAVEMENT LAYER SURFACE TO BE PREPARED AND TACK COATED IN ACCORDANCE WITH DPTI MASTER SPECIFICATION (INCLUDING CRACK SEALING, TACK COATING OR OTHER TREATMENTS AS APPROPRIATE).
- JOINT TO BE CRACKED SEALED AT SURFACE 6 MONTHS AFTER OPENING, IF REQUIRED.
- ADOPT THE SUPPLEMENT FOR ANY JOINT DETAILS NOT PROVIDED IN THESE DRAWINGS (DRG NUMBERS TO BE PROVIDED).
- FOR TEMPORARY PAVEMENTS LESSER STANDARDS MAY BE APPROPRIATE.
- THESE JOINT DETAILS ARE NOT APPLICABLE FOR TRENCH REINSTATEMENTS, FOR THESE REFER TO DPTI DOCUMENT (NUMBER TO BE PROVIDED).
- BLUE LINE CORRESPONDS TO PREPARED JOINT FACE AND PRIMED.
- WHERE WEARING COURSE CHANGES AT JOINT DRAINAGE MUST BE CONSIDERED, e.g. OGA TO DGA JOINT.

INDEX SHEET REFERENCE: N/A SHEET N/A



Government of South Australia
 Department of Planning, Transport and Infrastructure

PROJECT No.: FILE No.:
 DESIGN No.: SURVEY No.:
 PROJECT START ROAD RUNNING DISTANCE:
 PROJECT END ROAD RUNNING DISTANCE:

STANDARD DRAWING
PAVEMENT JOINT DETAILS
 SHEET 2 OF 4

DESIGNED: PAS	DRAFTED: GE	ACCEPTED FOR USE: COSTA TSEMTSIDIS	ACCEPTANCE FORM KNET No.: 14092259	DRAWING No.: 95272	SHEET No.: 2	AMEND No.: 0
CHECKED: PAS	CHECKED: PAS	TITLE: PRINCIPAL PAVEMENT ENG	IN ACCORDANCE WITH DP013	SHEET LATITUDE N/A	SHEET LONGITUDE N/A	
NOT TO SCALE		DATE: 9/10/19				

No.	AMENDMENT DESCRIPTION	BY	CHECK	ACCEPTANCE	DATE	UNCONTROLLED COPY WHEN PRINTED	100 MILLIMETRES ON ORIGINAL DRAWING	ALL DIMENSIONS ARE IN METRES UNLESS SHOWN OTHERWISE