

South Eastern Freeway - Managed Motorway Measures Project: Ramp Closures and Carriageway Restrictions

Dear Resident / Business Owner,

The South Eastern Freeway - Managed Motorway Measures Project, jointly funded (50:50) by the Australian and South Australian governments, is scheduled to undertake night carriageway closures and weekend ramp occupations throughout October 2020, weather permitting.

The project will convert the existing emergency lane into a third full time travel lane and implement a Managed Motorway on both the up and down tracks of the South Eastern Freeway between Crafers and Stirling. The three lane Managed Motorway will include an Intelligent Transport System, with variable speed limits and a Lane Use Management system. This will enable the allocation and control of lanes across the freeway to improve safety and traffic flow.

To safely undertake these works, night time carriageway closures and weekend ramp occupations are required.

There will be temporary detours and traffic restrictions in place commencing Tuesday, 6 October 2020, from 10pm, weather permitting.

Dates and times for the scheduled works are listed with the maps below.

These dates may change due to weather or conditions on site. Updates will be advised on Variable Message Signs and the Department for Infrastructure and Transport (the Department) will regularly update social media and the project's web page (refer below) with any changes.

Road users are asked to please plan ahead and allow extra travel time, observe speed limits, lane restrictions, traffic controllers and take extra care when travelling through the area.

Some noise disturbance can be expected at times while these works are completed, however the work will be managed to minimise disturbance to local residents and businesses as much as practically possible. Please email the address below to be added to our mailing list for updates if these works are rescheduled due to weather.

dit.sa.gov.au

Follow us on:    



Australian Government

BUILDING OUR FUTURE



Government
of South Australia

Department for Infrastructure
and Transport



If you have any questions or would like to speak to a member of the project team, please call 1300 794 880, email DIT.communityrelations@sa.gov.au or visit the project website www.dit.sa.gov.au/managedmotorway.

The Department appreciates your co-operation and patience while these important works are undertaken.

Kind regards,

Community Engagement and Stakeholder Team
Department for Infrastructure and Transport



Carriageway Closure (Inbound) - between Stirling Off-Ramp and Crafers Off-Ramp

- Tuesday, 6 October, between 10:00pm - 6:00am for erection of gantry beams and line marking
- Wednesday, 7 October, between 10:00pm - 6:00am for erection of gantry beams and line marking

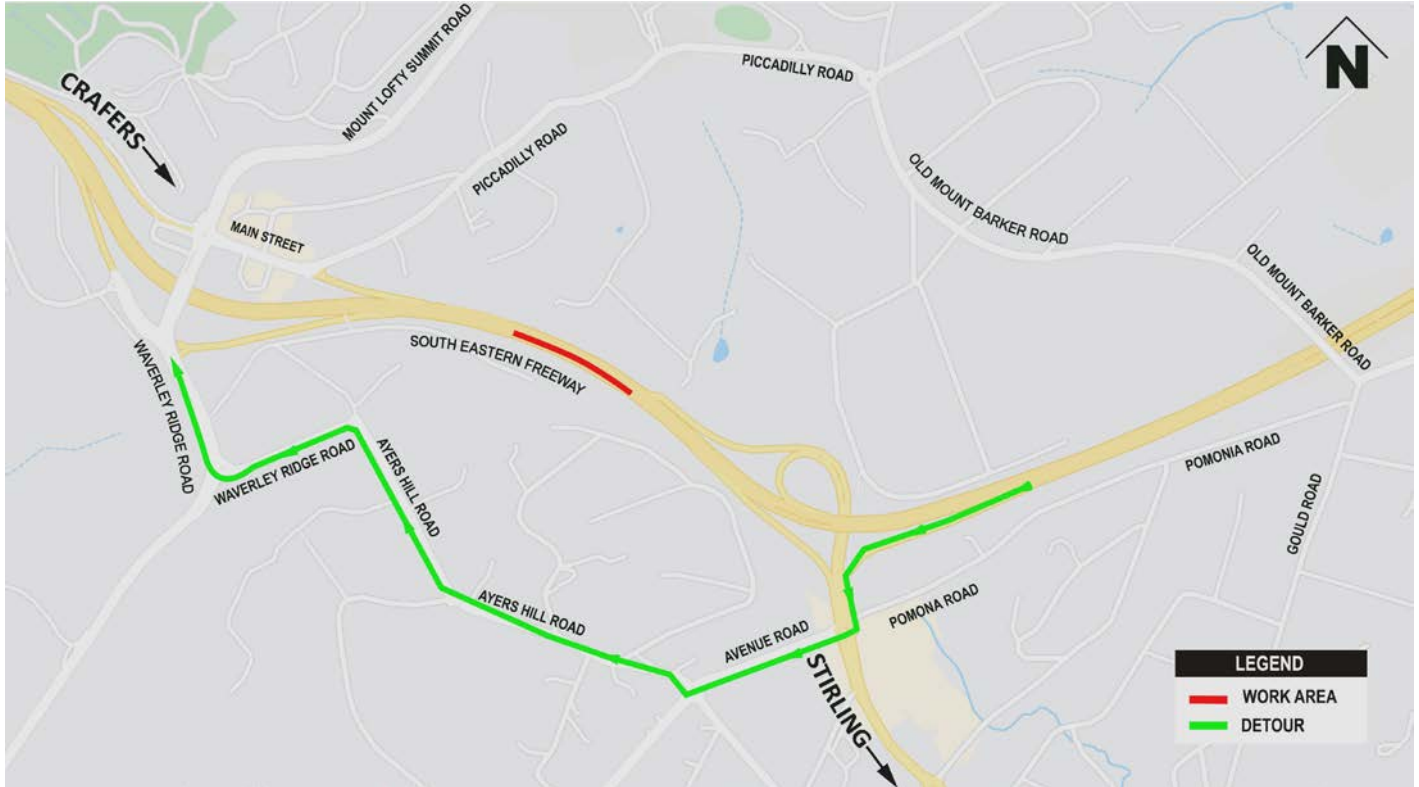

Carriageway Closure (Inbound) - between Crafers Off-Ramp and Crafers On-Ramp

- Thursday, 8 October, between 10:00pm - 6:00am for erection of gantry beams
- Friday, 9 October, between 10:00pm - 6:00am for erection of gantry beams



Weekend Ramp Occupation (Outbound) - Stirling Off-Ramp

- Friday, 9 October, 7:00pm until Monday, 12 October, 3:00pm for pavement construction

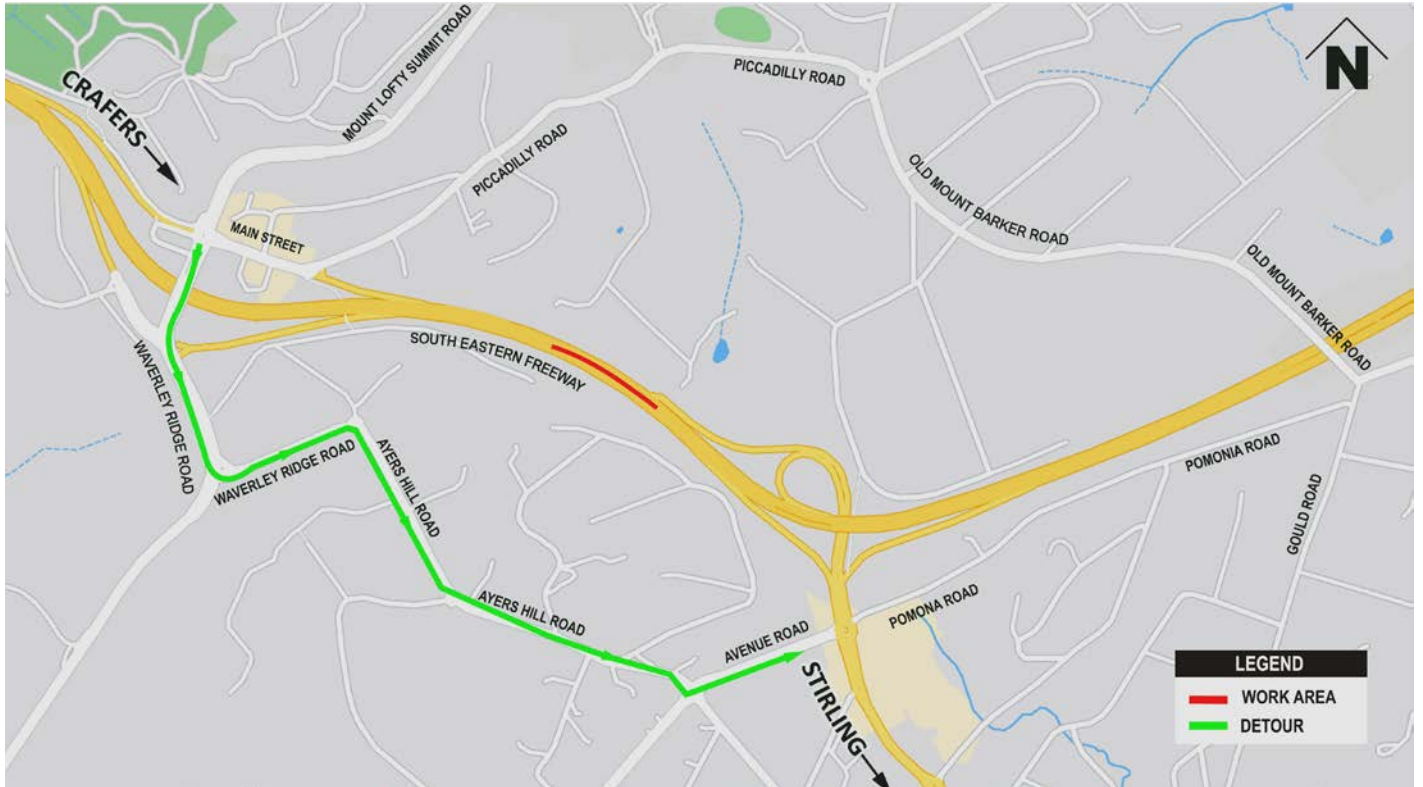

Weekend Ramp Occupation (Inbound) - Crafers Off-Ramp

- Friday, 16 October, 9.30am until Monday, 19 October, 6:00am for pavement construction

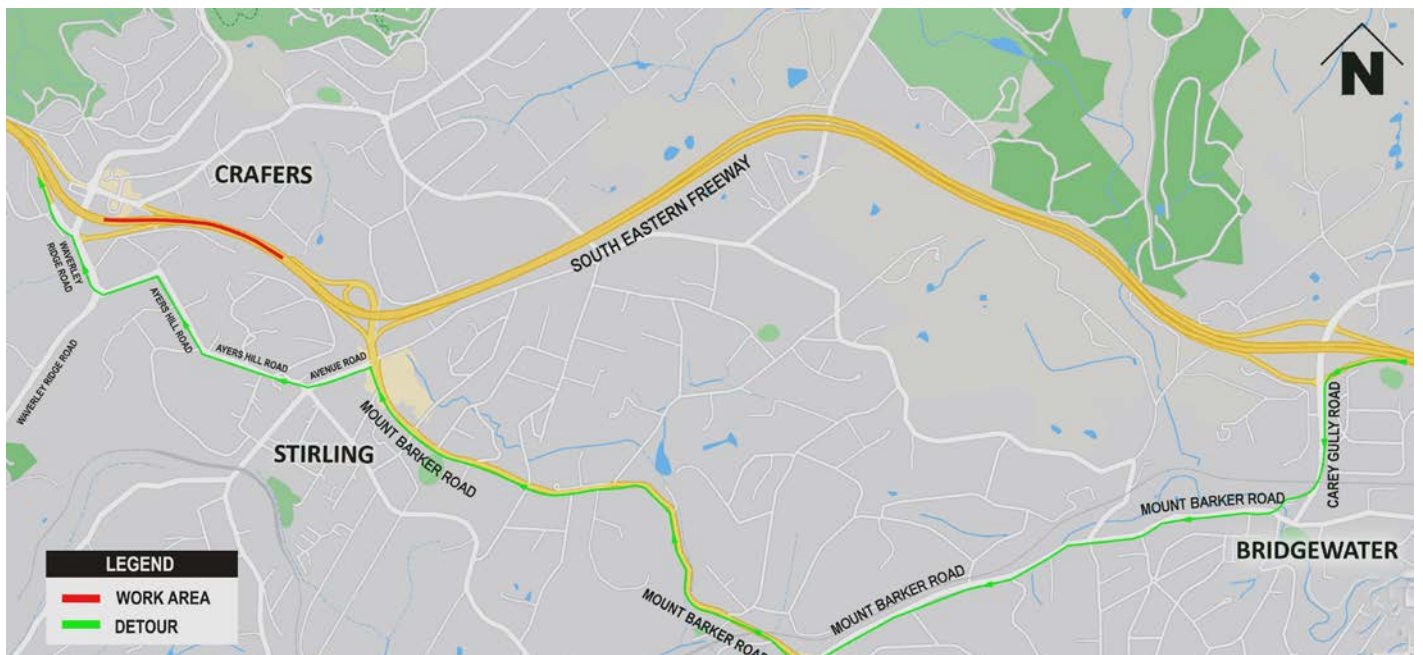

Carriageway Closure (Outbound) - between Crafers Off-Ramp and Crafers On-Ramp

- Monday, 19 October, between 10pm - 6:00am for erection of gantry beams

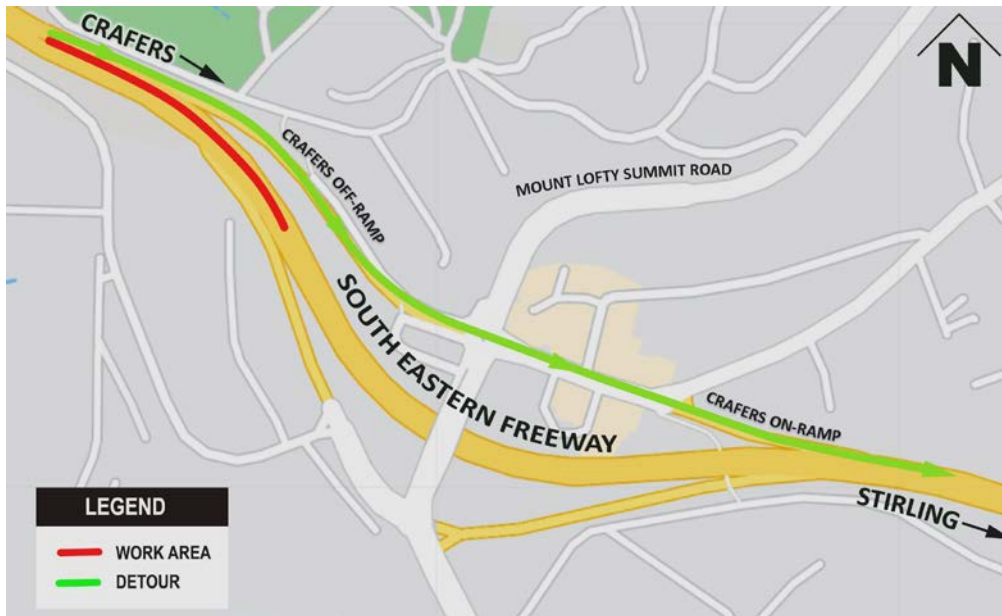

Carriageway Closure (Outbound) - between Crafers Off-Ramp and Stirling On-Ramp

- Tuesday, 20 October, between 10pm - 6:00am for erection of gantry beams

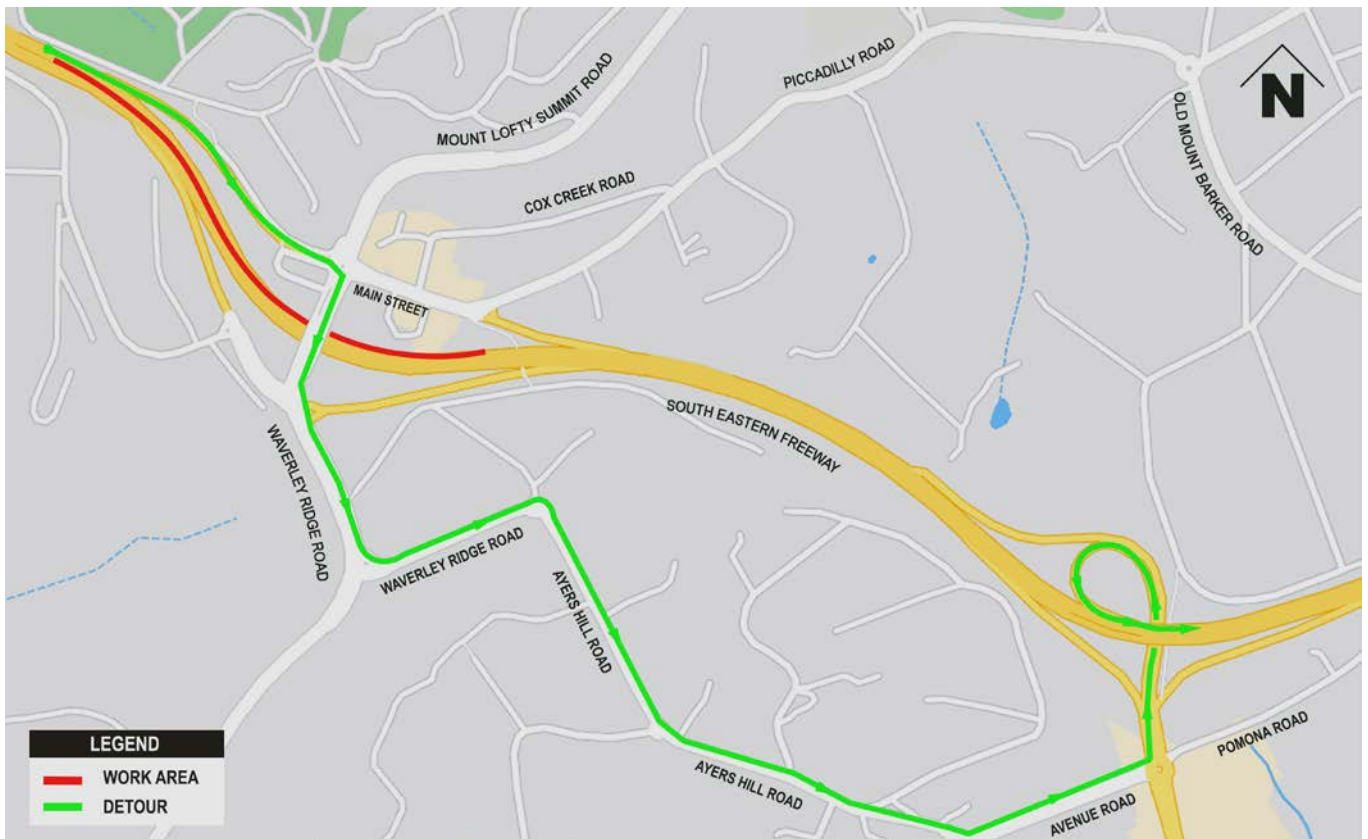

Carriageway Closure (Outbound) - between Stirling Off-Ramp and Stirling On-Ramp

- Wednesday, 21 October, between 10pm - 6:00am for erection of gantry beams
- Thursday, 22 October, between 10pm - 6:00am for erection of gantry beams

