



South Eastern Freeway Pavement Rehabilitation – Crafers to Crafers West

Weekend Crafers ramp and freeway lane closures

Upcoming weekend works

Stage 7 pavement works are underway on the South Eastern Freeway, between the Crafers Interchange and Crafers West. Works to complete this stage of pavement rehabilitation will be undertaken **continuously over the weekend from 7pm Friday, 8 October 2021, until 6am Monday, 11 October 2021**, weather permitting.

Planned traffic changes

To safely undertake these works, the following traffic arrangements will be in place during this weekend work:

Citybound lanes from east of the Crafers Interchange to west of Measday Bridge	<ul style="list-style-type: none"> citybound lanes will be temporarily closed during the weekend works; vehicles will be directed onto the opposite side of the freeway to allow travel in each direction to be maintained; and one lane of traffic will operate in the outbound direction and two lanes of traffic will operate in the citybound direction (with the exception of a short section of the freeway between Crossover 5 and just west of the Crafers Interchange, where citybound traffic will be reduced to one lane).
Citybound Crafers Interchange on-ramp closed	<ul style="list-style-type: none"> temporarily closed during the weekend works; citybound vehicles will be required to use the Stirling Interchange due to the Crafers Interchange citybound on-ramp closure; local access to streets (Hillcrest Avenue, Atkinson Road and Castle Close) will remain open at all times; and access to the Crafers Interchange Park 'n' Ride and bus stop 24 (citybound side) will remain available at all times.
Mount Barker Road citybound off-ramp (Measday Bridge) at Crafers West	<ul style="list-style-type: none"> temporarily closed during the weekend works; while closed, vehicles will need to continue travelling citybound on the freeway and use the inbound off-ramp at the Mount Osmond Interchange and then the outbound on-ramp to access the freeway. Vehicles will then need to use the outbound Mt Barker Road off-ramp at Leawood Gardens to access Mount Barker Road.
Citybound travel	<ul style="list-style-type: none"> speeds for citybound light and heavy vehicles will be reduced to 40km/h from east of the Crafers Interchange to west of Measday Bridge.
Outbound travel	<ul style="list-style-type: none"> speeds for outbound light and heavy vehicles will be reduced to 40km/h from west of Measday Bridge to east of the Crafers Interchange.

In the event of inclement weather, these works will be rescheduled to occur the following weekend from 7pm Friday, 15 October until 6am Monday, 18 October 2021.

dit.sa.gov.au

Follow us on:



Australian Government

BUILDING OUR FUTURE



Government
of South Australia



**BUILDING
WHAT MATTERS**

Bus stop 24 (south side) on the Crafers Interchange citybound on-ramp will remain open at all times.

Buses collecting patrons from bus stop 24 will be detoured via the Stirling Interchange due to the Crafers Interchange citybound on-ramp closure. Signage will be installed in advance on the bus stop advising of this temporary change. Patrons should expect delays during the weekend works.

Please refer to the map over the page for more information about planned detours.

Heavy vehicles (permit restrictions may apply), including buses, will have access on the freeway throughout the works, with the lower and upper safety ramps available at all times.

Important information for heavy vehicles

Heavy vehicles greater than 3.4 metres wide are currently not permitted to travel in either direction on the South Eastern Freeway between the Glen Osmond Tollgate and the Stirling Interchange without a permit.

Where travel is not permitted, the detour is via Old Princes Highway, Karoonda Highway, Burdett Road, Bowhill Road (Council road), Morell Road Bowhill (Council road), Hunter Road, Stott Highway Swan Reach, Hunter Road to Sturt Highway Blanchetown (and vice versa).

Heavy Vehicle operators may apply for permits to travel with widths greater than 3.4 metres or oversize and over mass requirements. Please contact the National Heavy Vehicle Regulator (NHVR) directly to apply for this permit, website www.nhvr.gov.au

About the project

The Department for Infrastructure and Transport (the Department) is undertaking major pavement rehabilitation works on the South Eastern Freeway between the Glen Osmond Tollgate and the Crafers Interchange. This \$35 million project is jointly funded (80:20) by the Australian and South Australian governments under the South Eastern Freeway Pavement Rehabilitation Stimulus 2.

The works involve removing around 300 millimetres deep of existing pavement and replacing it with new asphalt. Major asphaltting works such as these were last undertaken on this section of the freeway over 20 years ago. These works will ensure the long term safety and integrity of the freeway for all road users.

The works are being undertaken in stages, with a section of one carriageway (either uphill or downhill) closed at a time and vehicles detoured onto the adjacent carriageway. During this time, one lane of traffic will operate in the uphill direction and two lanes will operate in the downhill direction, on the one carriageway.

Pavement rehabilitation works at the intersection of the South Eastern Freeway with Portrush Road, Cross Road and Glen Osmond Road will now form part of this project and are expected to commence in late 2021, and be completed in early 2022.

Further information

For more information on the project or to register for project updates, please contact the project team via:

- **visit:** www.dit.sa.gov.au/SEFreeway
- **email:** dit.communityrelations@sa.gov.au **telephone:** 1300 103 456
- **SitePodium:** stay up to date with the project via the SitePodium app, visit www.dit.sa.gov.au/seffreeway for details on how to download the app.
- **Addinsight:** get real-time traffic alerts whilst you are driving with the Addinsight smartphone app, visit www.addinsight.com.au

The Department appreciates your patience and cooperation while these important works are undertaken.

Kind Regards,
South Eastern Freeway Pavement Rehabilitation Project Team



Crafers Interchange to Crafers West, citybound lanes

Weekend occupation traffic restrictions: 7pm Friday, 8 October – 6am Monday, 11 October (weather permitting)

Speed Restrictions

During weekend works, speeds for citybound and outbound light and heavy vehicles will be restricted to 40km/h from east of the Crafers Interchange to just west of Measday Bridge.

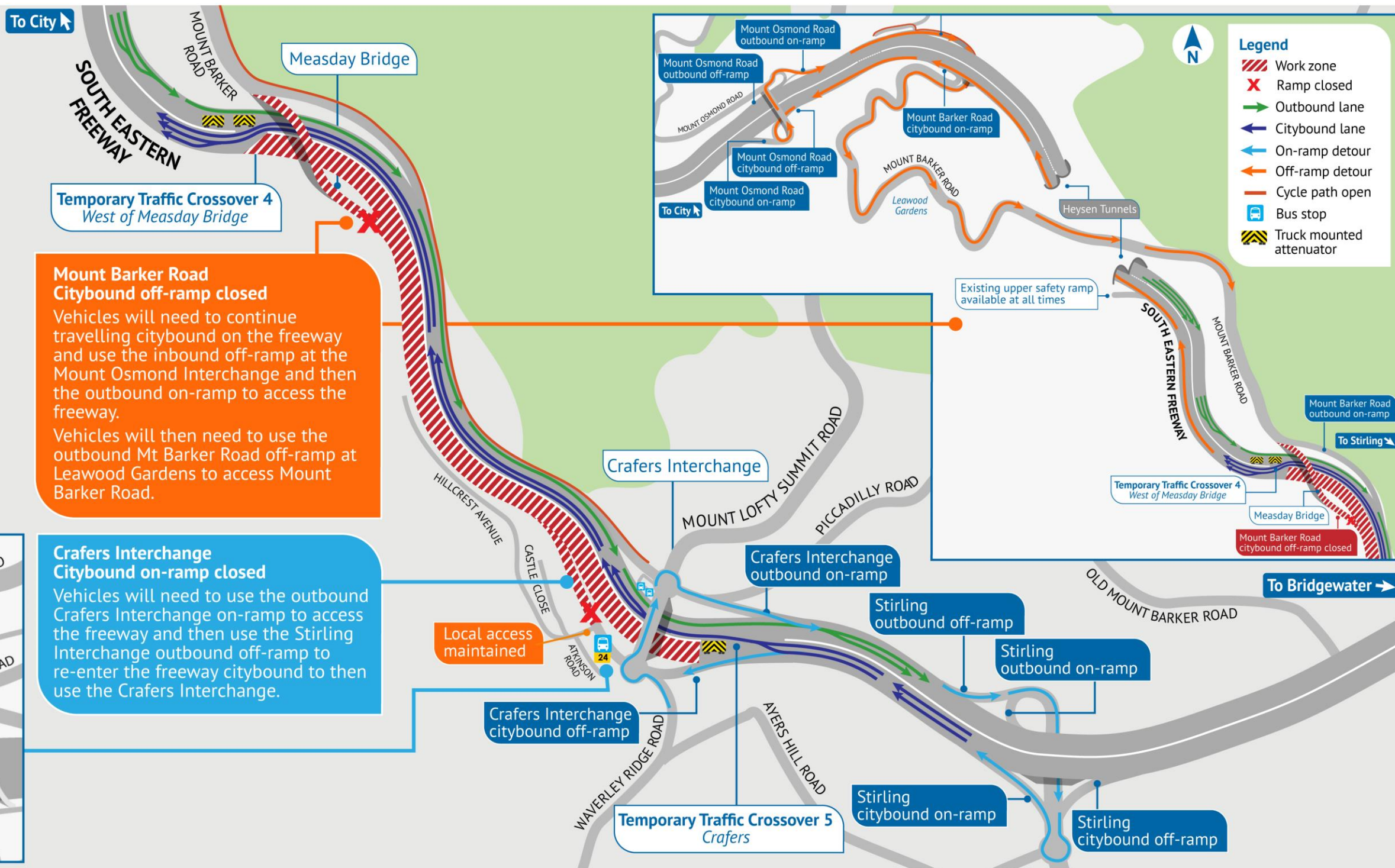

Mount Barker Road Citybound off-ramp closed
 Vehicles will need to continue travelling citybound on the freeway and use the inbound off-ramp at the Mount Osmond Interchange and then the outbound on-ramp to access the freeway.
 Vehicles will then need to use the outbound Mt Barker Road off-ramp at Leawood Gardens to access Mount Barker Road.

Crafers Interchange Citybound on-ramp closed
 Vehicles will need to use the outbound Crafers Interchange on-ramp to access the freeway and then use the Stirling Interchange outbound off-ramp to re-enter the freeway citybound to then use the Crafers Interchange.

