

Darlington Upgrade Project

Main South Road night works

Tuesday 10 March

As part of the Darlington Upgrade Project, night works will be undertaken to install a gantry sign on Main South Road, requiring a temporary closure of **Main South Road (northbound) surface road between Sturt Road and the Tonsley Boulevard exit ramp from 8pm, Tuesday 10 March, until 6am, Wednesday, 11 March. Please see map overleaf for further details.**

Traffic restrictions:

- The northbound Main South Road surface road will be closed between Sturt Road and the Tonsley Boulevard exit ramp.
- Northbound traffic will be detoured via Sturt Road and Shepherds Hill Road (see pink arrows on the map overleaf).
- Access to Flinders Drive will not be impacted during these works (see orange arrows on the map overleaf).
- Bus stop 26 on the western side of Main South Road will remain open during these works with services detoured via Main South Road, Sturt Road and Shepherds Hill Road.
- Bus Stop 24A on the western side of South Road will be temporarily closed during these works.
- For further information please visit www.adelaidemetro.com.au

Local residents in the Tonsley triangle are reminded that the Mimosa Terrace / Sutton Road bridge is now operational, which provides access to Sturt Road and Shepherds Hill Road to travel northbound on South Road.

Access for emergency service vehicles will be maintained at all times during these closures. Pedestrian and cycle access will be maintained at all times.

Please plan ahead, allow extra travel time and take extra care when workers are on site. Observe speed limits, lane restrictions and traffic controllers when travelling through the area.

If you have any questions or would like to speak to a member of the project team, please call 1300 759 334 or email: enquiries@gatewaysouth.com.au

Thank you for your patience while these important works are undertaken.

Kind Regards,
Darlington Upgrade Project Team
6 March 2020

Main South Road restrictions

March

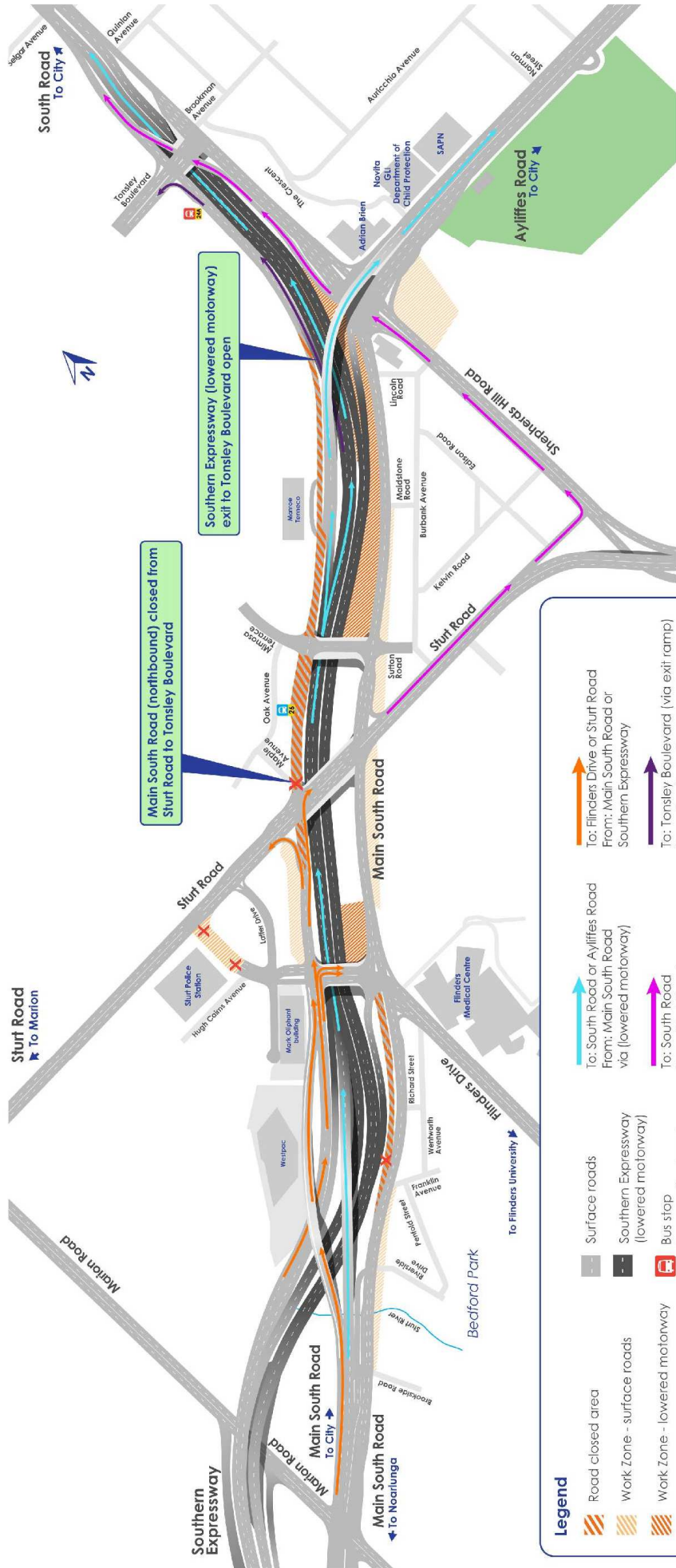

Legend

- Road closed area
- Work Zone - surface roads
- Work Zone - lowered motorway
- Bus stop temporarily closed during construction
- Road closed

- To: South Road or Ayliffes Road
From: Main South Road via (lowered motorway)
- To: South Road
From: Sturt Road via Shepherds Hill Road
- To: Flinders Drive or Sturt Road
From: Main South Road or Southern Expressway
- To: Tonsley Boulevard (via exit ramp)
From: Southern Expressway (lowered motorway)