



South Eastern Freeway Pavement Rehabilitation – Crafers West to Crafers

Weekend works and changed traffic conditions

Stage 6 weekend works

Works to complete stage 6 of pavement rehabilitation will be undertaken **continuously over the weekend from 7pm Friday, 15 October until 6am Monday, 18 October 2021**, weather permitting. Work will occur on the outbound lanes of the freeway, from Crafers West to just east of the Crafers Interchange.

Planned traffic changes

To safely undertake these works, the following traffic arrangements will be in place:

Outbound and citybound lanes from just west of Measday Bridge to just east of the Crafers Interchange	<ul style="list-style-type: none"> the outbound lanes will be temporarily closed during the weekend works; vehicles will be directed onto the opposite side of the freeway to travel outbound; and one lane of traffic will operate in the outbound direction and two lanes will operate in the citybound direction.
Mount Barker Road outbound on-ramp at Crafers West	<ul style="list-style-type: none"> temporarily closed during the weekend works; and vehicles will need to travel west on Mount Barker Road and use the inbound on-ramp at Leawood Gardens to access the freeway and then use the Mount Osmond off-ramp to turn around and travel back in an outbound direction on the freeway.
Outbound Crafers Interchange off-ramp (entry to Crafers) closed	<ul style="list-style-type: none"> temporarily closed during the weekend works; and vehicles will need to continue travelling outbound on the freeway, use the Stirling Interchange and either re-enter the freeway citybound to then use the Crafers Interchange or alternatively, vehicles can turn left at the roundabout onto Pomona Road, then left onto Gould Road, then continue into Crafers via Old Mount Barker Road.
Citybound travel	<ul style="list-style-type: none"> speeds for citybound light and heavy vehicles will be restricted to 40km/h from east of the Crafers Interchange to just west of Measday Bridge.
Outbound travel	<ul style="list-style-type: none"> speeds for outbound light and heavy vehicles will be restricted to 40km/h from just west of Measday Bridge until just east of the Crafers Interchange.

In the event of inclement weather, these works will be rescheduled to occur the following weekend from 7pm Friday, 22 October until 6am Monday, 25 October 2021.

Please refer to the map over the page for more information.

dit.sa.gov.au

Follow us on:



Australian Government

BUILDING OUR FUTURE



Government
of South Australia



**BUILDING
WHAT MATTERS**

Bus stops on the freeway, including the Crafers Interchange stops will not be impacted, however bus patrons and commuters should expect delays.

Heavy vehicles (permit restrictions may apply), including buses, will have access on the freeway throughout the works, with the lower and upper safety ramps available at all times.

Important information for heavy vehicles

Heavy vehicles greater than 3.4 metres wide are currently not permitted to travel in either direction on the South Eastern Freeway between the Glen Osmond Tollgate and the Stirling Interchange without a permit.

Where travel is not permitted, the detour is via Old Princes Highway, Karoonda Highway, Burdett Road, Bowhill Road (Council road), Morell Road Bowhill (Council road), Hunter Road, Stott Highway Swan Reach, Hunter Road to Sturt Highway Blanchetown (and vice versa).

Heavy Vehicle operators may apply for permits to travel with widths greater than 3.4 metres or oversize and over mass requirements. Please contact the National Heavy Vehicle Regulator (NHVR) directly to apply for this permit, website www.nhvr.gov.au

About the project

The Department for Infrastructure and Transport (the Department) is undertaking major pavement rehabilitation works on the South Eastern Freeway between the Glen Osmond Tollgate and the Crafers Interchange. This \$35 million project is jointly funded (80:20) by the Australian and South Australian governments under the South Eastern Freeway Pavement Rehabilitation Stimulus 2.

The works involve removing around 300 millimetres of existing pavement and replacing it with new asphalt. Major asphaltting works such as these were last undertaken on this section of the freeway over 20 years ago. These works will ensure the long term safety and integrity of the freeway for all road users.

The works will be undertaken in stages, with a section of one carriageway (either uphill or downhill) closed at a time and vehicles detoured onto the adjacent carriageway. During this time, one lane of traffic will operate in the uphill direction and two lanes will operate in the downhill direction, on the one carriageway.

Further information

For more information on the project or to register for project updates, please contact the project team via:

- **visit:** www.dit.sa.gov.au/SEFreeway
- **email:** dit.communityrelations@sa.gov.au
- **telephone:** 1300 103 456
- **SitePodium:** stay up to date with the project via the SitePodium app, visit www.dit.sa.gov.au/sefreeway for details on how to download the app.
- **Addinsight:** get real-time traffic alerts whilst you are driving with the Addinsight smartphone app, visit www.addinsight.com.au

The Department appreciates your patience and cooperation while these important works are undertaken.

Kind Regards
South Eastern Freeway Pavement Rehabilitation Project Team



Crafers West to Crafers Interchange, outbound lanes

Weekend traffic restrictions: 7pm Friday, 15 October – 6am Monday, 18 October 2021

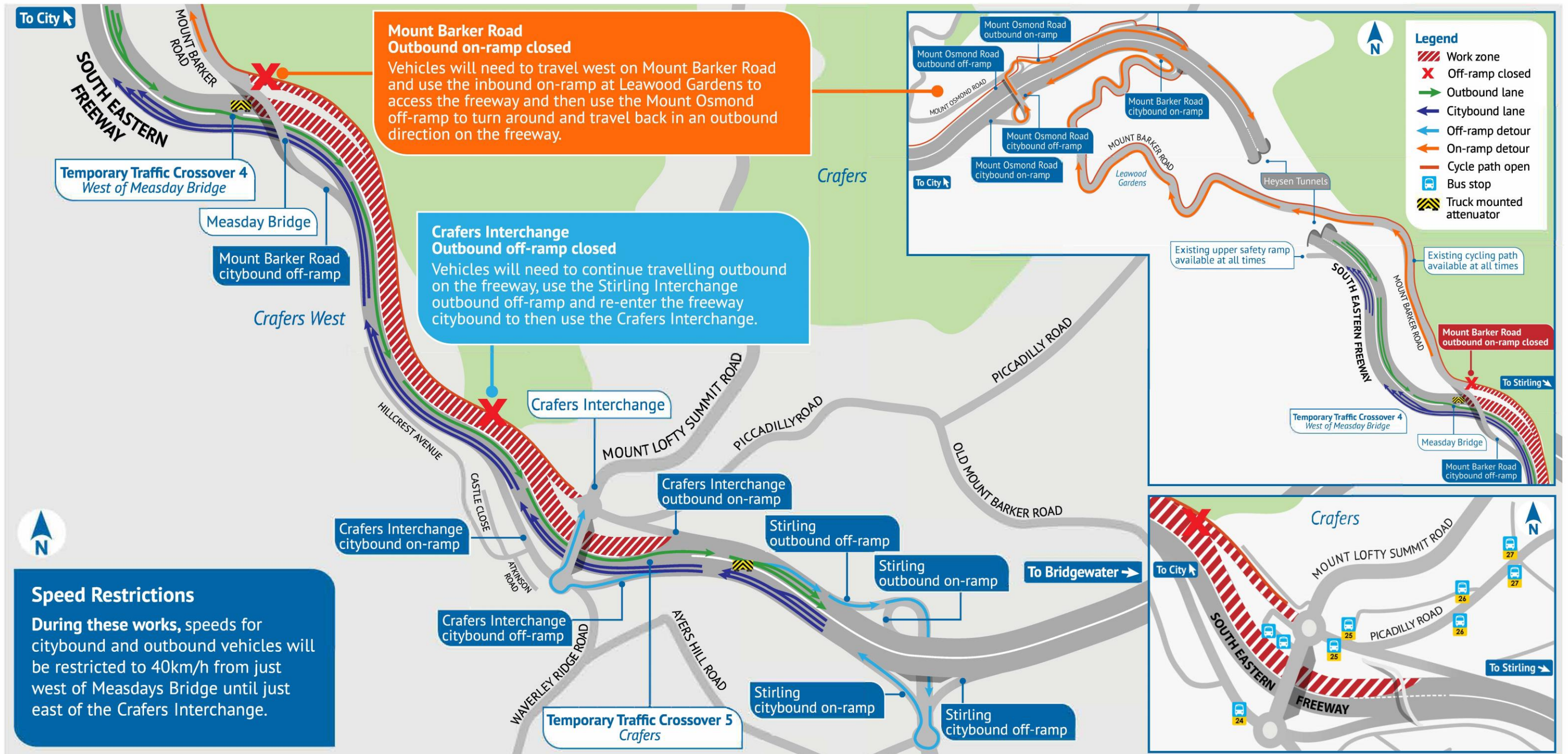

www.dit.sa.gov.au/SEFreeway

1300 103 456

Follow us on:

