

FOSROC 'CONBEXTRA HF', OR APPROVED SIMILAR, CEMENTITIOUS NON-SHRINK GROUT USED FOR GROUTING OPERATION IN ACCORDANCE WITH THE MANUFACTURER'S RECOMMENDATION

PROVIDE SLOT (*) IN CONDUIT FROM TOP OF CONDUIT TO U/S BASE PLATE TO ALLOW DRAINAGE.

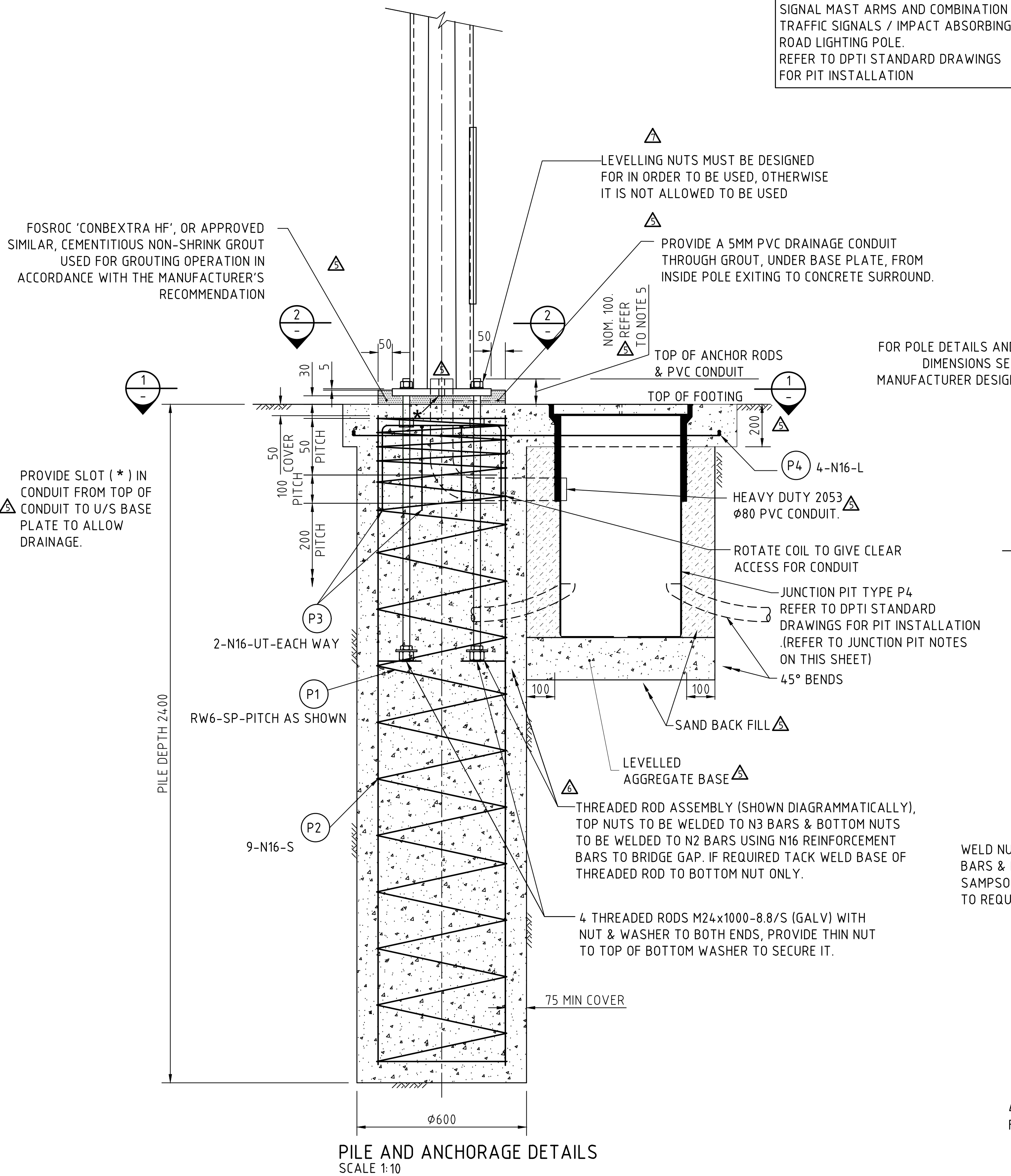

PILE AND ANCHORAGE DETAILS
SCALE 1:10

JUNCTION PIT NOTES:
TYPE P2 PIT TO BE USED FOR IMPACT ABSORBING ROAD LIGHTING POLE.
TYPE P4 PIT TO BE USED FOR TRAFFIC SIGNAL MAST ARMS AND COMBINATION TRAFFIC SIGNALS / IMPACT ABSORBING ROAD LIGHTING POLE.
REFER TO DPTI STANDARD DRAWINGS FOR PIT INSTALLATION

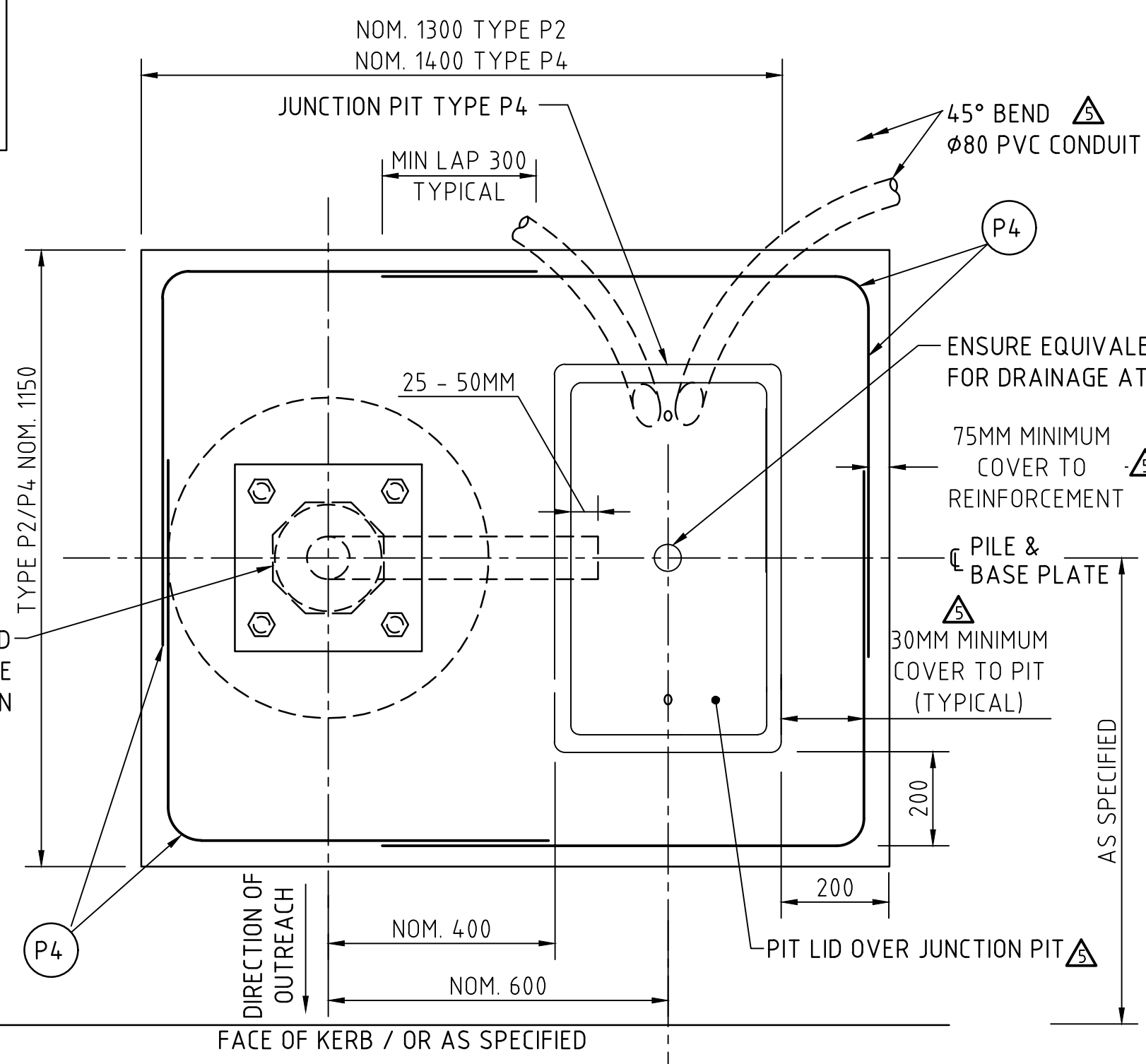

SECTION 1
SCALE 1:10

FOOTING FOR COMBINATION TRAFFIC SIGNAL ROAD LIGHTING MAST ARM POLES & MAST ARMS, AND FOR REPLACEMENT OF EXISTING ABOVE GROUND STANDARD & COMBINATION ROAD LIGHTING POLES.

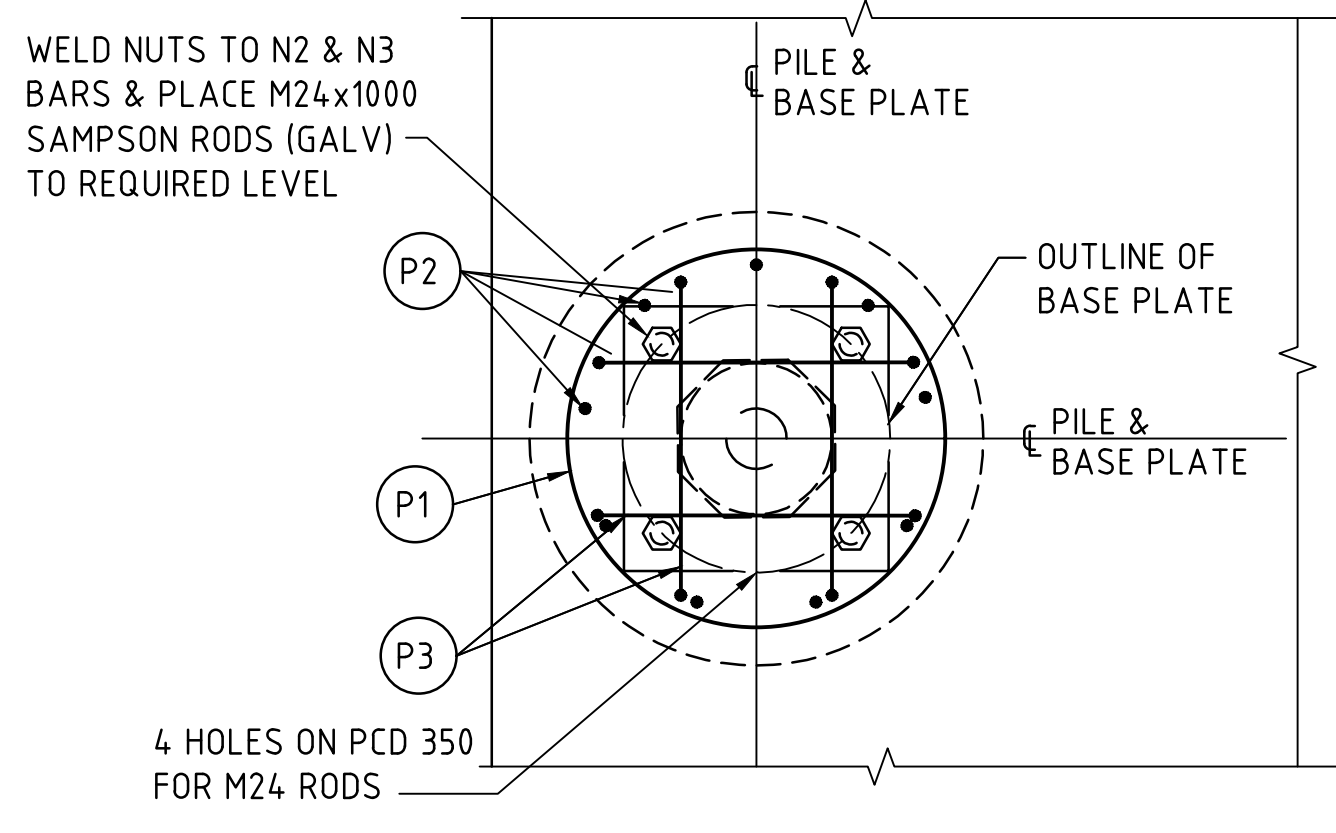

SECTION 2
SCALE 1:10

BAR	DESCRIPTION	NO. REQD.	SHAPE CODE	BENDING
P1	RW6	1	SP	
P2	N16	9	S	
P3	N16	4	UT	
P4	N16	4	L	

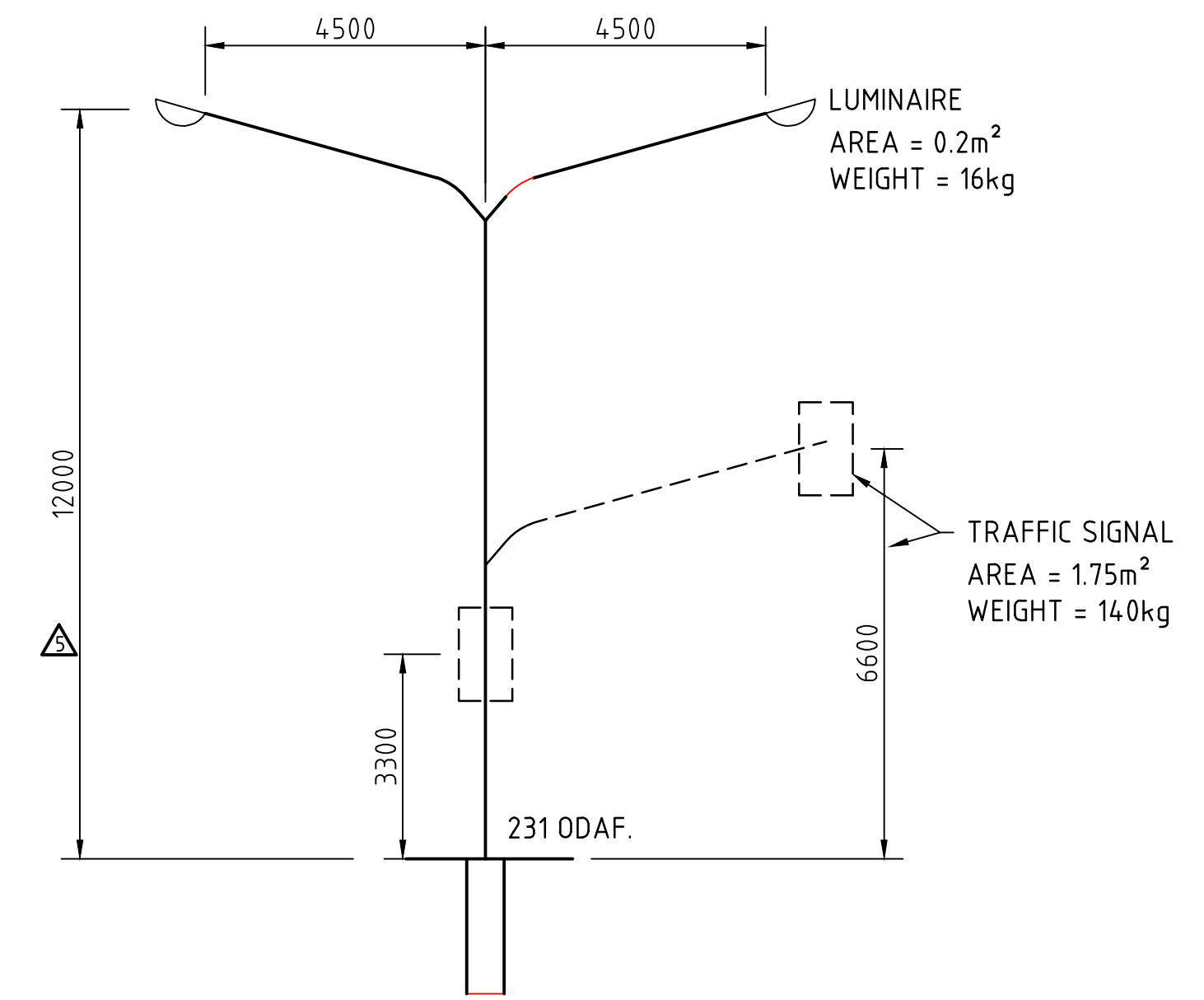

DESIGN MODEL FOR ROAD LIGHTING POLES AND COMBINATION TRAFFIC SIGNAL/ROAD LIGHTING MAST ARM

NOTES

DESIGN

- THIS FOOTING IS SUITABLE FOR LIGHT POLES AND TRAFFIC SIGNAL MAST ARMS AS SHOWN ON DIAGRAM ABOVE.
- LEVELLING NUTS MAY ONLY BE USED WITH APPROVAL FROM DIT TECHNICAL SERVICES.

MATERIALS

- CONCRETE TO BE GRADE N32.
- MINIMUM COVER TO REINFORCEMENT TO BE 75mm UNLESS SHOWN OTHERWISE.
- REINFORCEMENT BARS SHALL BE D500N AND D500L(RW) IN ACCORDANCE WITH AS/NZS 4671. STANDARD HOOKS AND BENDS IN ACCORDANCE WITH AS 3600.
- THREADED ANCHOR RODS TO BE GRADE 8.8, NUTS AND WASHERS IN ACCORDANCE WITH AS 1252. ANCHOR RODS, NUTS AND WASHERS SHALL BE HOT DIP GALVANISED IN ACCORDANCE WITH AS 1214 (BOLTS AND NUTS), AND AS/NZS 4680 (WASHERS). ALL NUTS TO BE TAPPED OVERSIZE TO ACCOMMODATE GALVANISING.
- PROJECTION OF THREADED RODS FROM THE TOP AND BOTTOM NUT FACE SHALL BE 6MM MINIMUM IN ACCORDANCE WITH AS 4100

FOUNDATION

- FOOTINGS NOT TO BE INSTALLED IN LOOSE SAND OR FILL, SOFT CLAY, WET SOILS NEAR TO UNDERGROUND SERVICES OR ON SLOPES GREATER THAN 10 DEGREES. FOR SUCH LOCATIONS ADVICE TO BE SOUGHT FROM STRUCTURAL ENGINEER.

ELECTRICAL WIRING

- FOR DETAILS OF JUNCTION PIT AND POLE WIRING REFER TO STANDARD DRAWING S-4055, SHEET 46.

No.	AMENDMENT DESCRIPTION	BY	CHECK	ACCEPTANCE	DATE
1	TITLE BLOCK UPDATE, LEVELLING NUT DELETED	JACOBS	PM	P MOLLOY	30/10/20
2	AMENDMENTS TO ANNOTATION & REINFORCEMENT, DWG SUPERSEDES SHT 63 ADDED.	HD	PM	P MOLLOY	14/6/17
3	NOTE & DIMENSIONS ADDED	LM/MD	PM	S PASCALE	5/4/16
4	THIN NUT ADDED TO THREADED RODS & LENGTH IN P1 BAR REINFORCEMENT CHANGED	AP	PM	P MOLLOY	21/6/13
5	REINFORCEMENT & NOTES AMENDED	AP	PM	P D WILSON	05/05/08
6	DRAWING REDRAWN IN DIFFERENT FORMAT REINFORCEMENT CHANGED, DIMENSIONS ADDED & CHANGED P4 PIT REPLACING P2 PIT	AP	RB	P D WILSON	23/11/07
7	P1 REPLACED BY P2 IN PLAN VIEW	CE	RB	P BLAKE	7/12/01

SUPERSEDES DRAWING S-4055, SHEET 28 & 63

DESIGNED	QUALIFICATION DATE: DD/MM/YYYY
REVIEWER	QUALIFICATION DATE: DD/MM/YYYY
INDEPENDENT DESIGN CERTIFIER (IF REQUIRED)	QUALIFICATION DATE: DD/MM/YYYY



DESIGNED: R. LEWITH		ACCEPTED FOR USE: R. LEWITH		ACCEPTANCE FORM KNET No.:		DRAWING No.:		SHEET No.:		AMEND No.:	
DATE: 24/06/99		DATE: 24/06/99				S - 4055		30		7	
LATTITUDE:		LONGITUDE:									